

QUANTUM® QG20

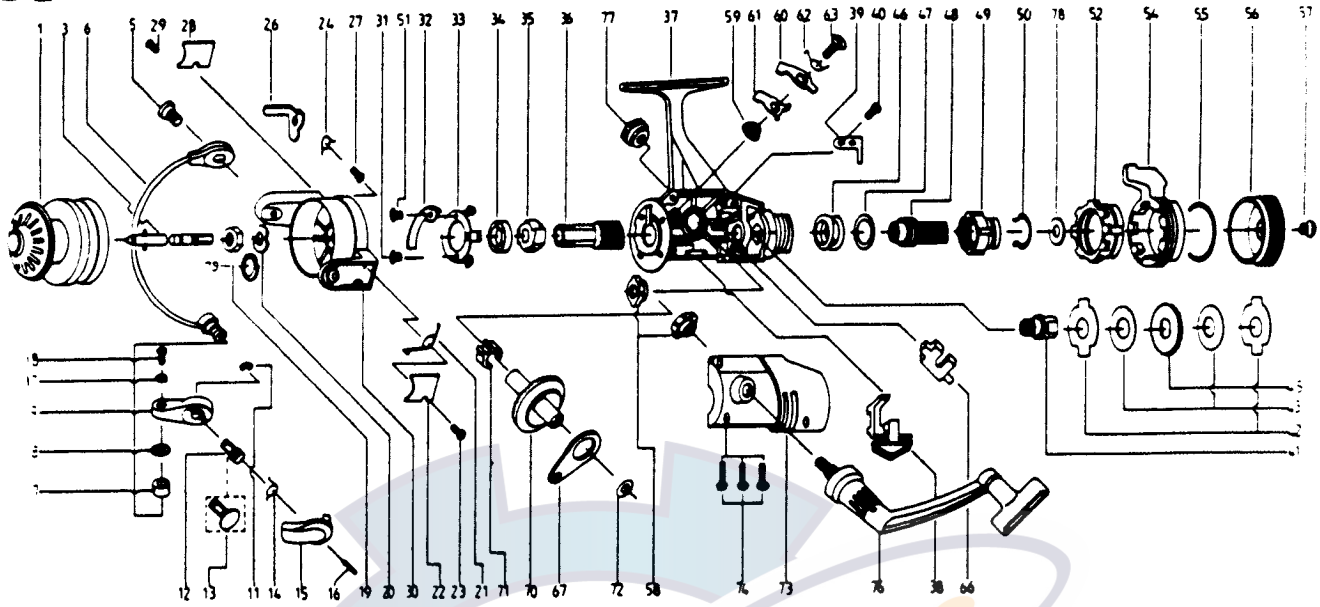

KEY PART NO. NO.	DESCRIPTION	PRICE	KEY PART NO. NO.	DESCRIPTION	PRICE
1	HT321 SPOOL ASSEMBLY	5.68	41	CT104 SLIDER HOLDER	.63
3	CT315 MAIN SHAFT	2.46	42	CT030 REAR DRAG WSHR "A"	1.27
4	CT044 BAIL HOLDER PIN	1.14	43	CT039 REAR DRAG WASHER "B"	1.43
6	CT347 BAIL ARM ASSY.	4.99	44	CT071 REAR DRAG WASHER "D"	1.03
7	NB004 LINE ROLLER	1.09	46	CT031 REAR DRAG COIL SPR.	1.14
8	NB016 LINE ROLLER BUSH.	.63	47	CT046 REAR DRAG ADJ. WSHR.	1.03
9	CT007 ARM LEVER	1.72	48	CT112 REAR DRAG NUT	1.09
11	BT002 E-CLIP	.85	49	CT017 SLIDING SCREW	1.14
12	CT113 TRIGGER HOLDER	.58	50	CT033 BACK CLICK CLAW	.39
13	CT111 ARM LEVER CAP	1.14	51	BT182 KICK LEVER GUIDE SCR	.39
14	BT114 TRIGGER SPRING	.52	52	HT093 FIGHTING FULL SCR.	1.72
15	BT115 TRIGGER	1.43	54	HT094 FIGHTING LEVER	4.02
16	BT116 TRIGGER PIN	.39	55	HT095 FT. LVR. STOP. RING	.85
17	NB102 BAIL AXLE WASHER	.29	56	HT032 REAR DRAG CAP	2.24
18	NB108 BAIL AXLE SCR	.58	57	VB079 DRAG SCREW	.92
19	VB006 ROTOR NUT	.58	58	BT013 BODY COVER BUSHING	.69
20	BT065 ROTOR RETAINER	.58	59	BT014 A/R CLAW BUSHING	.69
21	CT022 BAIL SPRING	.69	60	CT063 A/R CLAW (N)	.75
22	CT087 BAIL SPRING COVER	.69	61	CT064 A/R CLAW (S)	.80
23	BT085 BAIL SPR. COVER SCREW	.63	62	CT061 A/R CLAW SPRING	.39
24	CT049 KICK LEVER SPRING	.58	63	BT089 A/R CLAW SCREW	.34
26	CT019 KICK LEVER	1.27	66	BT081 PIN SLIDER	.80
27	BT037 KICK LEVER SCREW	.34	67	BT025 OSCILLATING SLIDER	1.27
28	RB024 TRIP LVR. CVR.	.63	70	CT012 DRIVE GEAR	3.55
29	BT085 BAIL SPR. COVER SCREW	.63	71	BT086 SLIDING SPRING	.46
30	CT009 ROTOR ASSY.	7.17	72	RB026 CRANK GEAR SHIM	.29
31	BT080 BEARING PLATE SCREW	.34	73	HT323 BODY COVER ASSY.	5.68
32	CT082 KICK LEVER GUIDE	.85	74	BT057 BODY COVER SCREW	1.14
33	CT040 BEARING PLATE	.85	76	HT318 HANDLE ASSEMBLY	6.42
34	RB028 BALL BEARING	5.73	77	HT073 HANDLE SCREW CAP	.69
35	BT060 RATCHET GEAR	1.83	78	CT046 REAR DRAG ADJ. WSHR.	1.03
36	CT011 PINION GEAR	3.55	79	CT120 ROTOR RET. SPRG. W/S	.92
37	HT301 BODY ASSEMBLY	11.18	* 80	HT005 BACK CLAW (FIGHTING)	1.09
38	CT059 ANTI-REVERSE LEVER	.58	* 81	HT018 FIGHTING CLICK WASHER	1.09
39	CT068 CLICK CLAW	.39			
40	BT067 CLICK CLAW SCREW	.29			

*Not shown in diagram

Key 80 fits between keys 49, 50
Key 81 fits between keys 52, 54

Prices subject to change without notice. Prices do not include postage and handling.

PLEASE ORDER BY PART NUMBER

Rev. 11/90

Zebco Division Brunswick Corporation, Box 270, Tulsa, OK 74101 USA 918-636-5581

